

hazendal - site plan

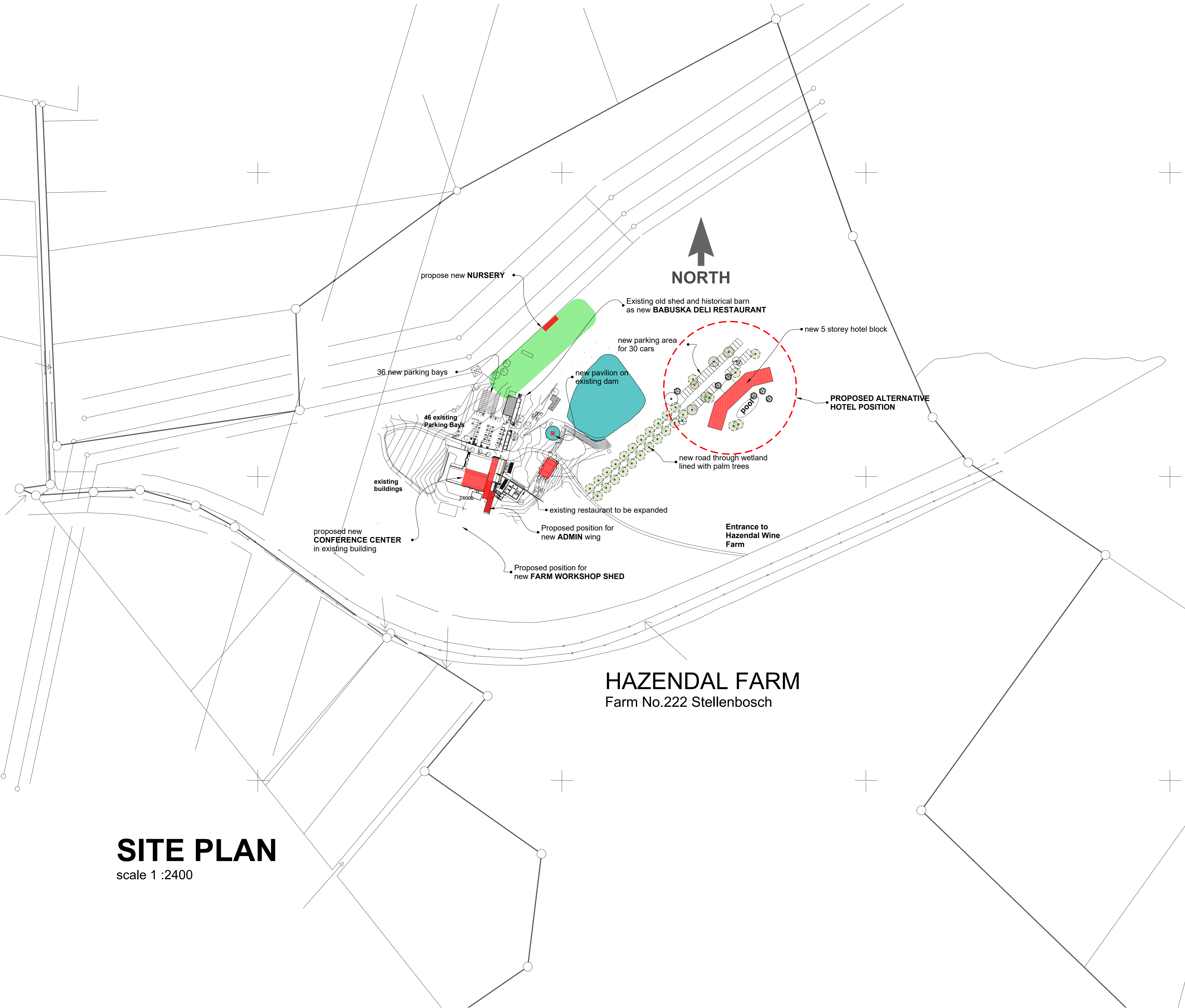

SITE PLAN
scale 1 :2400

HAZENDAL FARM
Farm No.222 Stellenbosch

notes:
 THE DESIGN ON THIS DRAWING IS COPYRIGHT AND REMAINS THE PROPERTY OF THE ARCHITECT
 ALL WORK TO COMPLY WITH THE CURRENT AND LOCAL BUILDING REGULATIONS
 THESE DRAWINGS MUST NOT BE SCALED WORK FROM FIGURED DIMENSIONS. ANY DISCREPANCIES TO BE REFERRED TO THE ARCHITECTS
 ALL RELEVANT DETAILS, LEVELS, DIMENSIONS TO BE CHECKED ON SITE BY THE CONTRACTOR BEFORE COMMENCEMENT OF ANY WORK OR SETTING OUT OF SHOP DRAWINGS
 ALL DRAWINGS ARE TO BE CHECKED BY THE MAIN CONTRACTOR AND ANY DISCREPANCIES ON OR BETWEEN THE DRAWING OR TO BE REFERRED TO THE ARCHITECTS
 ALL WORK TO COMPLY WITH THE LATEST EDITION OF THE MODEL PREAMBLES
 ALL STRUCTURAL, MECHANICAL AND ELECTRICAL WORK TO ENGINEER'S DETAILS
 THESE DRAWINGS ARE TO BE READ IN CONJUNCTION WITH THE ARCHITECTS DETAILS AND SCHEDULES
 THIS DRAWING MAY BE ISSUED ELECTRONICALLY BUT IS SUBJECT TO CROSS REFERENCING WITH THE LATEST DRAWING REGISTER

REVISIONS:

DATE	NO	DESCRIPTION
2016.05.02	00A	CONCEPT

HAZENDAL FARM
Farm No.222 Stellenbosch

Client
Mike Hackner

Mike Hackner Architects
 Suite 407A
 Sea Point Medical Centre
 15 Kloof Street
 Sea Point
 8005
 Cape Town
 Mob: 0767999666
 www.mikehacknerarchitects.com

MIKE HACKNER
architecture

SITE MASTER PLAN

29/9/2016
 plan number **HAZ- 001/03**